



www.mapbatterie.it

# BLP 12-100

## LITHIUM IRON PHOSPHATE BATTERY

### FEATURES

- Lithium Iron Phosphate (LiFePO4): the Safest Lithium Technology.
- Integrated Battery Management System(BMS).
- Bluetooth/RS485/RS232/SMBus/CANBus (Optional). SOC
- LED/LCD Indicator(Optional).

### PERFORMANCE

- Long Cycle Life>2000cycles @100% DOD.
- High Density, High Discharge Current, High Temperature Range.
- Low Weight, Free Maintenance. Fast Charging.
- Environment Friendly.

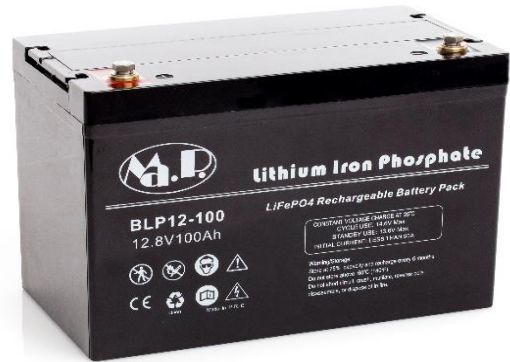

## BLP 12-100 (12.8V - 100Ah)

Electrical Parameters	
Nominal Voltage	12.8 V
Rated Capacity	100 Ah
Energy	1280 Wh
Resistance	≤ 30mΩ
Efficiency	99 %
Cycle Life	>2000cycles @1C,100% DOD
Self Discharge	2% per Month
Max.modules in series/parallel	4S/20P

Mechanical Parameters	
Dimension (L x W x H)	305 x 168 x 215 mm
	13.0 x 6.8 x 8.3"
Weight	13,6 kg (29.92 lbs)
Terminal Type	M8 Sx
Battery Housing	ABS, UL-94 V-0
Housing Protection	IP56
Cell Type-Chemistry	LiFePO4 Cylindrical Cell
SOC Display(Optional)	LED/LCD Indicator

Discharge Parameters	
Continuous Discharge Current	100 A
Pulse Discharge Current	600 A (< 5 seconds)
Recommended V disconnect	10 V
BMS discharge cut-off voltage	8 V
Reconnect Voltage	9,2 V
Short Circuit Protection	200~600 μs

Charge Parameters	
Charge Method	CC-CV
Charge Voltage	14.4 ~ 14.8V
Recommended Float Voltage	13.8 V
Recommended charge current	50 A
Maximum Charge Current	100 A
BMS Charge Cut-off Voltage	15.6 V

Compliance Certificate	
Certifications	UL 2054 (MH63377)
	CE
	IEC 62133 & CB
	KC
	BIS
Shipping Classification	UN 3480, Class 9, UN 38.3

Temperature Parameters	
Discharge Temperature	-30 to 60°C (-22 to 140°F)
Charge Temperature	0 to 45°C (32 to 113°F)
Storage Temperature	-40 to 60°C (- 40 to 140°F)
BMS High Temperature Cut-off	80°C (176°F)





www.mapbatterie.it

# BLP 12-100 (12.8V - 100Ah)

## Performance Characteristics

CYCLE LIFE vs.DEPTH OF DISCHARGE(DOD)  
DISCHARGE@1C, 25 C

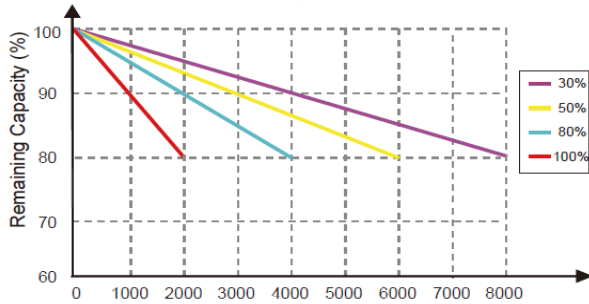

DISCHARGE CAPACITY at VARIOUS TEMPERATURES DISCHARGE  
@1C

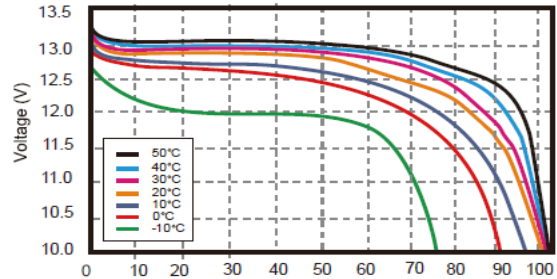

STATE OF CHARGE CURVE @0.5C, 25 C

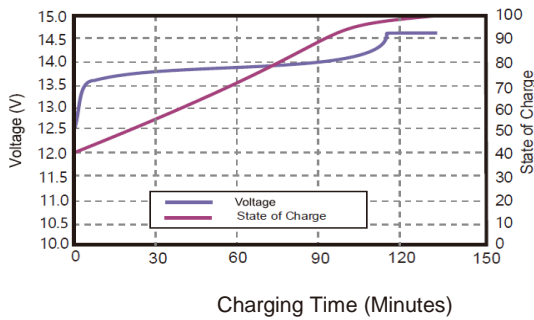

CHARGING CHARACTERISTICS @0.5C, 25 C

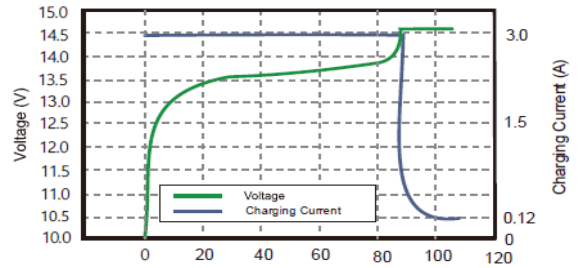

## Battery Layout

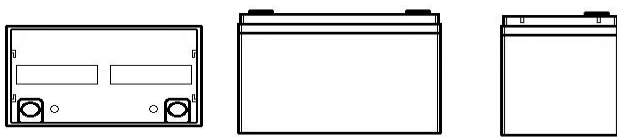

Terminal

M8

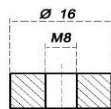
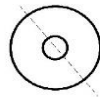

## Battery Applications

- Data Center UPS
- Telecom Backup Power
- Military Power Supply
- Solar Energy Storage System
- Solar Street LED Lightings
- Golf Trolley & Golf Carts
- Aerial Work Platform
- Floor Cleaning Machines
- Power Tools, Lawn Mower
- Electric Bike & Motorcycles
- Medical Devices
- Electric Ships
- Passenger Vehicles
- Autonomously Guided Vehicles (AGVs)
- Industrial Robotics & Handling Equipment
- Electric Mobilities( E-scooters, Wheelchair)

## Battery Recycle



Note: Do Not Mix With Sealed Lead Acid Batteries When Recycling

See MAP User's Manual for Proper Operation.

MAP BATTERIE. All Rights Reserved.